

# Basel Mission Archives

## "Plan der Winnebah Faktorei "

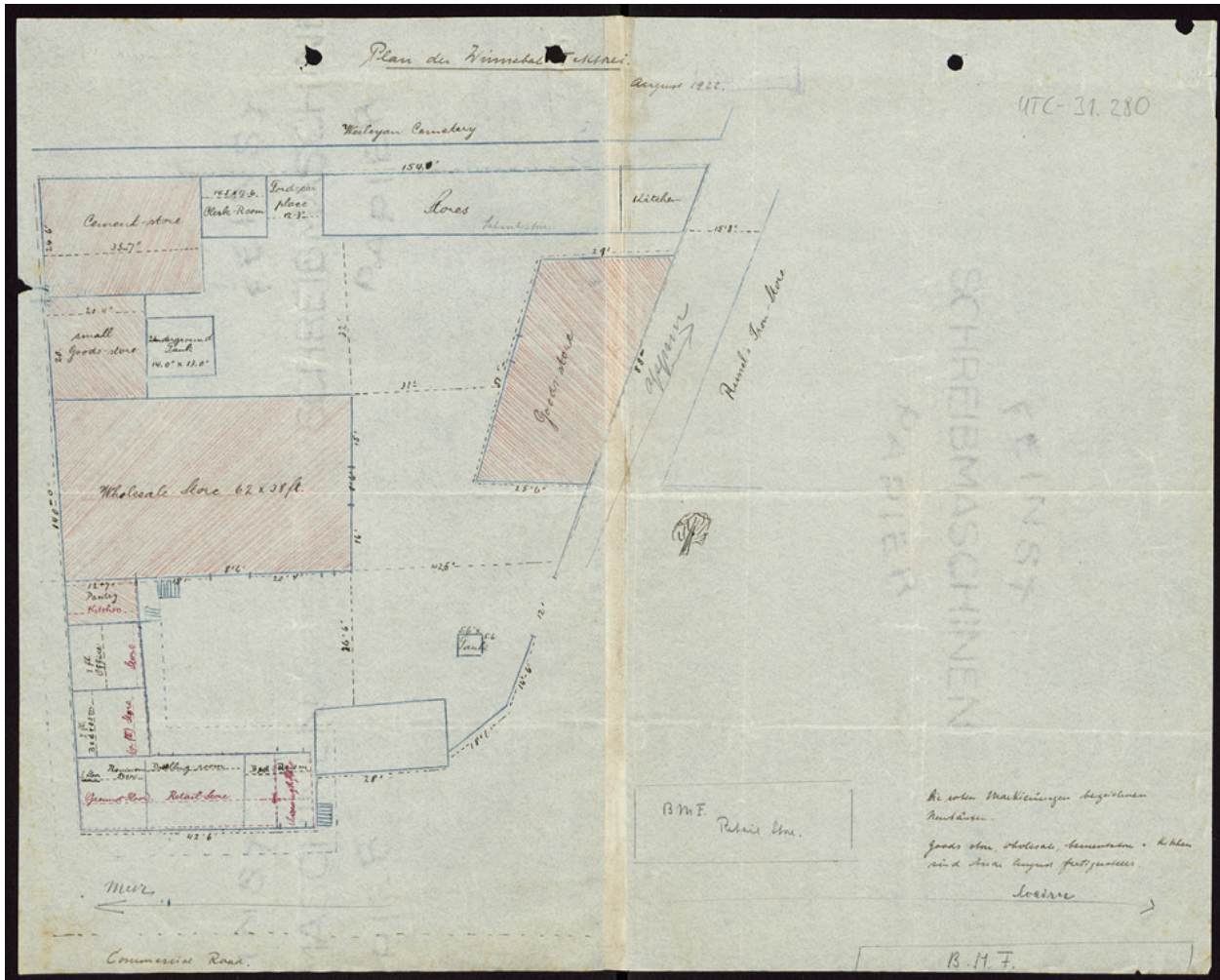

- Title:** "Plan der Winnebah Faktorei "
- Alternate title:** Plan of the Winnebah Factory
- Ref. number:** UTC-31.280
- Date:** Proper date: 1922
- Subject:** [Geography]: Africa {continent}: Ghana {modern state}: Ghana  
[Geography]: Winnebah  
[Archives catalogue]: Maps and plans: UTC: UTC-31
- Type:** Map
- Format:** [Format]: 33cm x 41cm  
[Condition]: -  
[Detail]: Station  
[Material]: Papier  
[Scale unit]: unbekannt  
[Relevance]: /

# Basel Mission Archives

---

- Ordering:** Please contact us by email [info@bmarchives.org](mailto:info@bmarchives.org)
- Contact details:** Basel Mission Archives/ mission 21, Missionstrasse 21, 4003 Basel, tel. (+41 61 260 2232), fax: (+41 61 260 2268), [info@bmarchives.org](mailto:info@bmarchives.org)
- Rights:** All the images (photographic and non- photographic) made available in this collection are the property of the Basel Mission / mission 21. The Basel Mission claims copyright on the images in their possession and requires those - both individuals and organisations - publishing any of the images, to pay a users fee.