

Basel Mission Archives

"Grundriss des neuen Mädchenanstaltsgebäudes auf der Station Hongkong. "

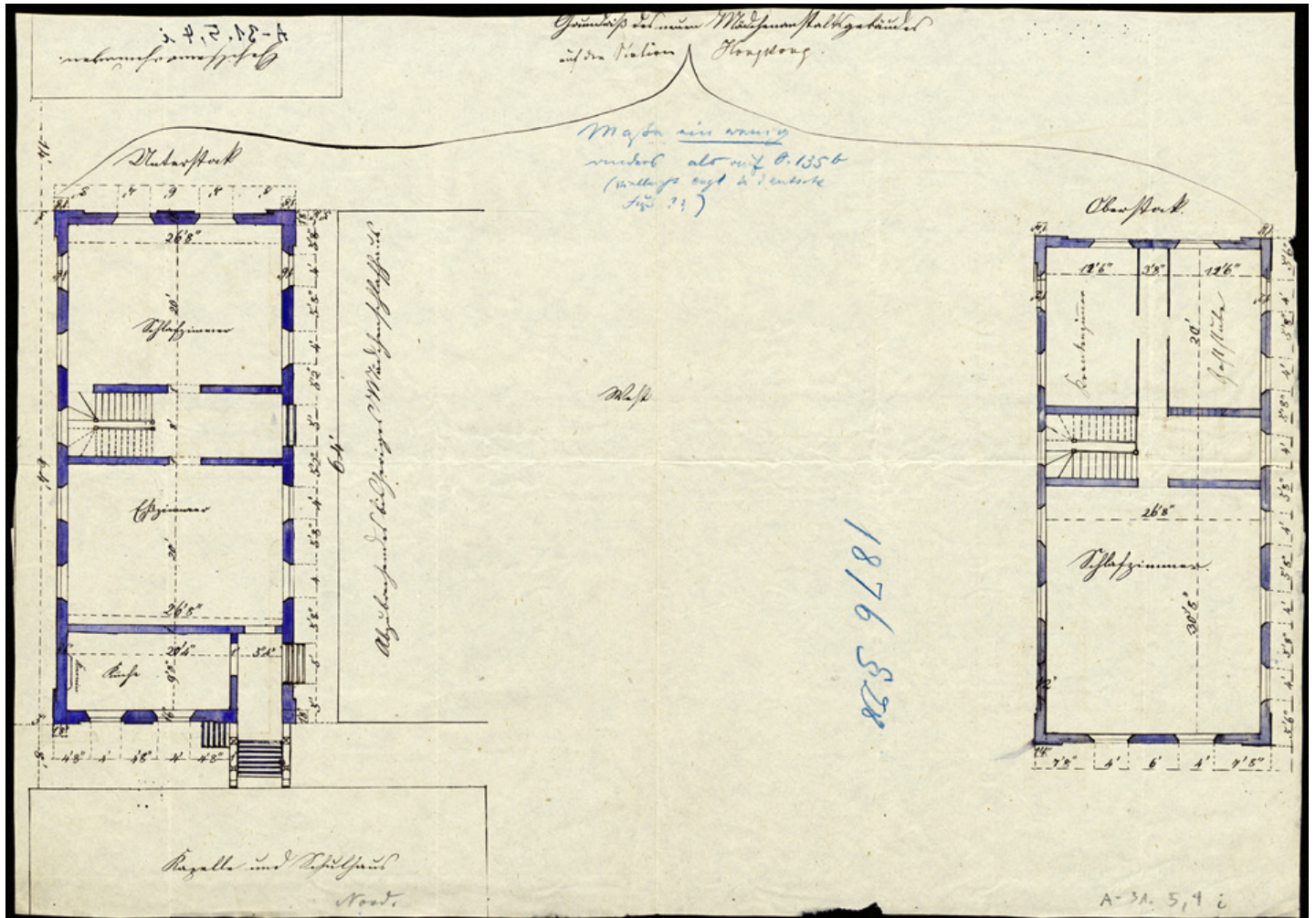

- Title:** "Grundriss des neuen Mädchenanstaltsgebäudes auf der Station Hongkong. "
- Alternate title:** Ground plan of the new girls' boarding school on the Hong Kong mission station.
- Ref. number:** A-031.05,04#i
- Date:** Date late: 1910
Proper date: 1872 - 1910
- Subject:** [Individuals]: Schulze, O.
[Geography]: China
[Geography]: Hongkong
[Archives catalogue]: Maps and plans: A - China: A-031 - Maps and sketches, plans of buildings China: A-031.05 - China. Mission station plans. Fophin to Kutschuk.: A-031.05,04
- Type:** Map
- Format:** [Format]: 29cm x 41cm

Basel Mission Archives

[Condition]: /
[Detail]: Haus
[Material]: papauslauf
[Relevance]: -
[Scale unit]: ohne Angabe

Ordering: Please contact us by email info@bmarchives.org

Contact details: Basel Mission Archives/ mission 21, Missionstrasse 21, 4003 Basel, tel. (+41 61 260 2232), fax: (+41 61 260 2268), info@bmarchives.org

Rights: All the images (photographic and non- photographic) made available in this collection are the property of the Basel Mission / mission 21. The Basel Mission claims copyright on the images in their possession and requires those - both individuals and organisations - publishing any of the images, to pay a users fee.