

# Basel Mission Archives

"Bauplan für das Zweig Hospital in Hokschuha China. "

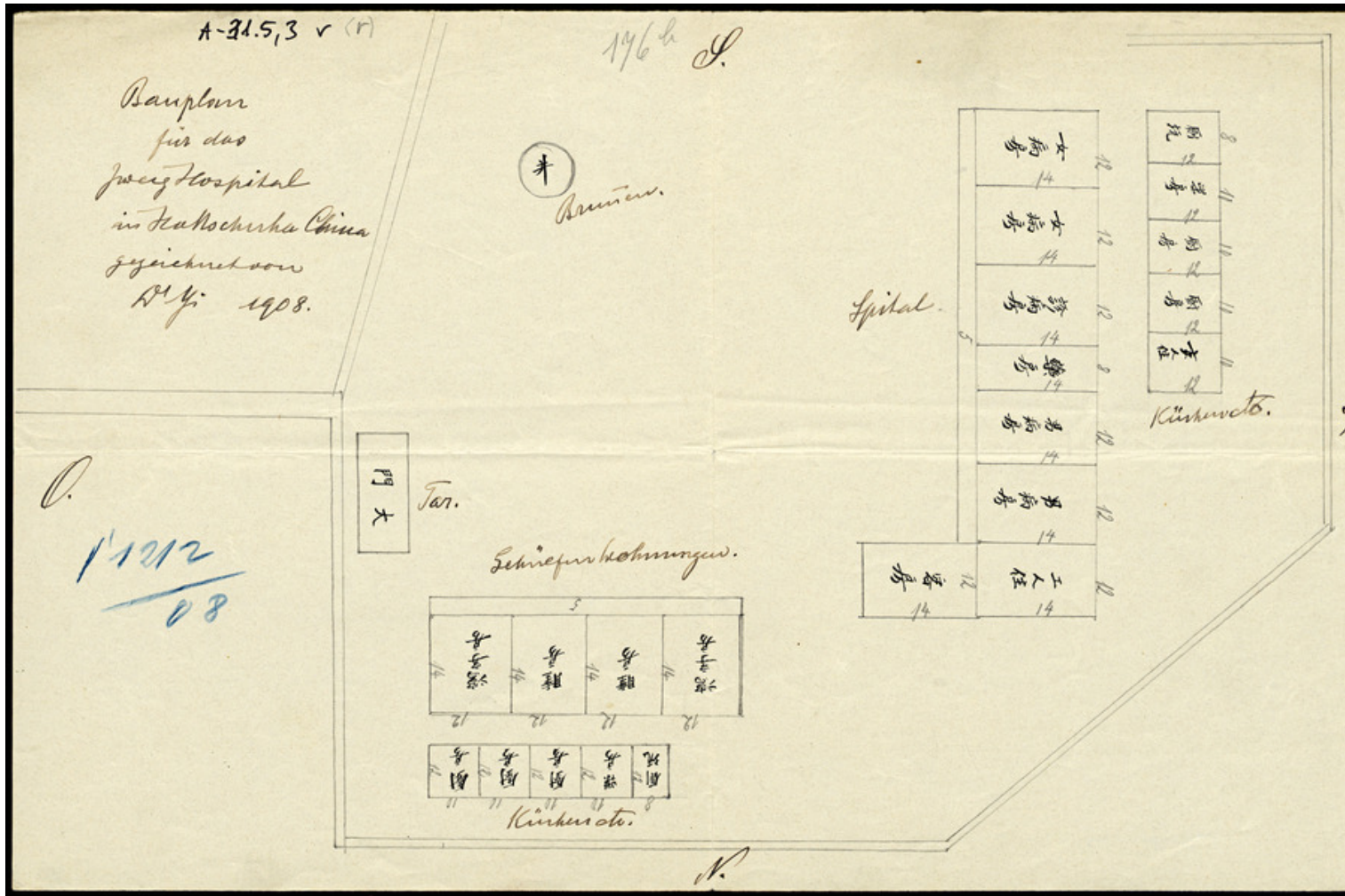

**Title:** "Bauplan für das Zweig Hospital in Hokschuha China. "

**Alternate title:** Building plan for the hospital branch in Hokschuha China.

**Ref. number:** A-031.05,03#r

**Date:** Date late: 1927  
Proper date: 1884 - 1927

**Subject:** [Individuals]: Schulze, O.  
[Geography]: China  
[Geography]: Hokschuha  
[Archives catalogue]: Maps and plans: A - China: A-031 - Maps and sketches, plans of buildings China: A-031.05 - China. Mission station plans. Fophin to Kutschuk.: A-031.05,03 - Hokschuha

**Type:** Map

**Format:** [Format]: 23cm x 36cm  
[Condition]: /

# Basel Mission Archives

---

[Detail]: Station  
[Relevance]: -

- Ordering:** Please contact us by email [info@bmarchives.org](mailto:info@bmarchives.org)
- Contact details:** Basel Mission Archives/ mission 21, Missionstrasse 21, 4003 Basel, tel. (+41 61 260 2232), fax: (+41 61 260 2268), [info@bmarchives.org](mailto:info@bmarchives.org)
- Rights:** All the images (photographic and non- photographic) made available in this collection are the property of the Basel Mission / mission 21. The Basel Mission claims copyright on the images in their possession and requires those - both individuals and organisations - publishing any of the images, to pay a users fee.